

VIB SC

Conical trunk Silentblocks

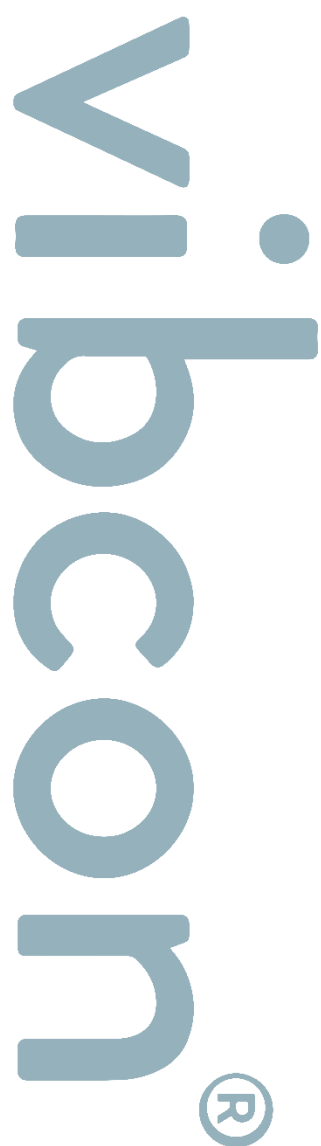

Index



Information.....1



Dimensions1



Assembly.....2



Information

The VIB SC series, is one of the most popular in the industrial sector and especially in air conditioning series.

This is due to its unique geometry, which allows a better dynamic behavior and stability to lateral forces in relation to other classic series, such as metal-rubber isolators and VIB S or VIB SD .

They are ideal for use in outdoor, since it does not crack or harden, remaining its characteristics for much longer natural features.

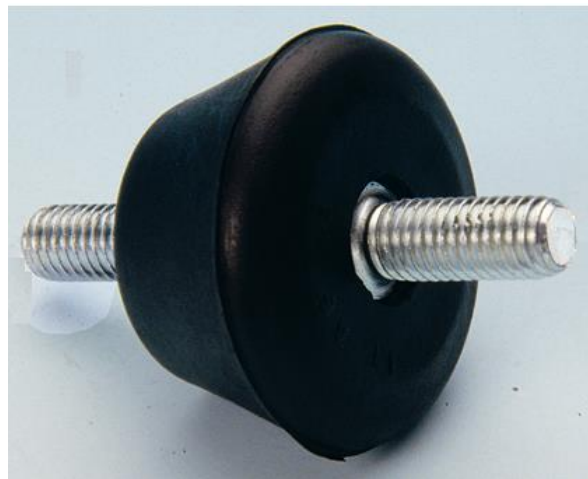

Dimensions

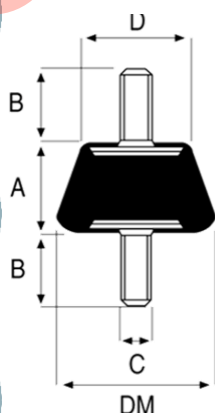

SC35 Y SC45

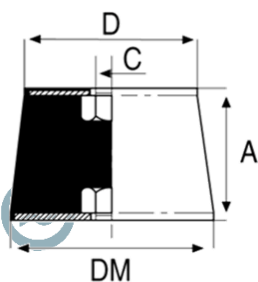

SC60 a SC130

Vibcon Models	Dimensions in mm.				
	A	B	C	D	DM
SC 35	24	20	M-8	28	40
SC 45	35	20	M-8	33	45
SC 60	48	-	M-12	60	70
SC 70	58	-	M-12	70	79
SC 90	60	-	M-12	90	99
SC 130	71	-	M18?	130	140

Vibcon Models	Compression static load (2) in daN (1)				
	MINIMUM load	MINIMUM Arrow in mm.	MAXIMUM load (4)	MAXIMUM Arrow in mm.	OPTIMAL ZONE(3) in daN
SC 35	10	1	80	4.5	15-65
SC 45	12	1	125	7	20-100
SC 60	20	1.5	300	10	40-250
SC 70	60	2	400	11	70-350
SC 90	75	2	750	13	100-650
SC 130	175	2	1500	14	250-1200

Note (1): daN. =1,02kp .

Note (2): The load values were obtained by testing dynamometers. The values are arithmetic values of loading and unloading of its hysteresis curve . In addition this products are exclusive of Vibcon and therefore are not comparable to another in the market.

Note (3): OPTIMUM working area is the part of linear behavior

Note (4): Permissible overload + 50% max.



Assembly

Note: The SC 35 and SC 45 does not support shear or tensile load, only compressive load.

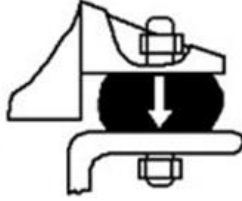

**in
compression**

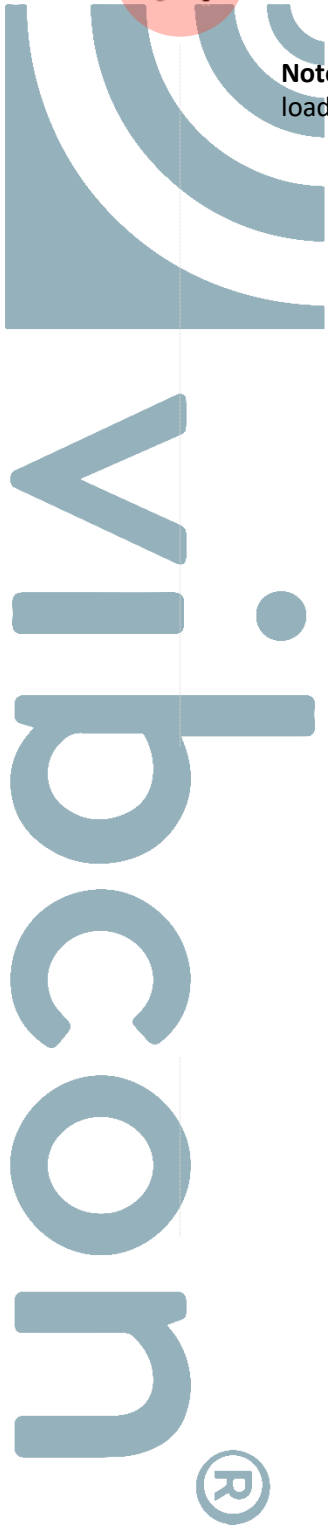



Vibroacústica Control y Aislamiento S.L.